

TITLE: Refresh Wall Brick/Block Existing with Horizontal Plank Outer Profile

DWG NO:  
DRAWN: EP  
CHECK: PCL  
DATE: May 2017  
SCALE: NTS

This draft drawing has been supplied by Euro Clad Ltd for the purpose of guidance free of charge. It is a suggested typical detail and as such should not be assumed suitable for any specific project or application. No responsibility is assumed for errors or misinterpretations resulting from the information contained in the drawing. Details are for illustration only and no liability is accepted. We reserve the right to change the details without notice. The drawing is copyright, it remains our property.

To be read in conjunction with Refresh guidance and specification documents

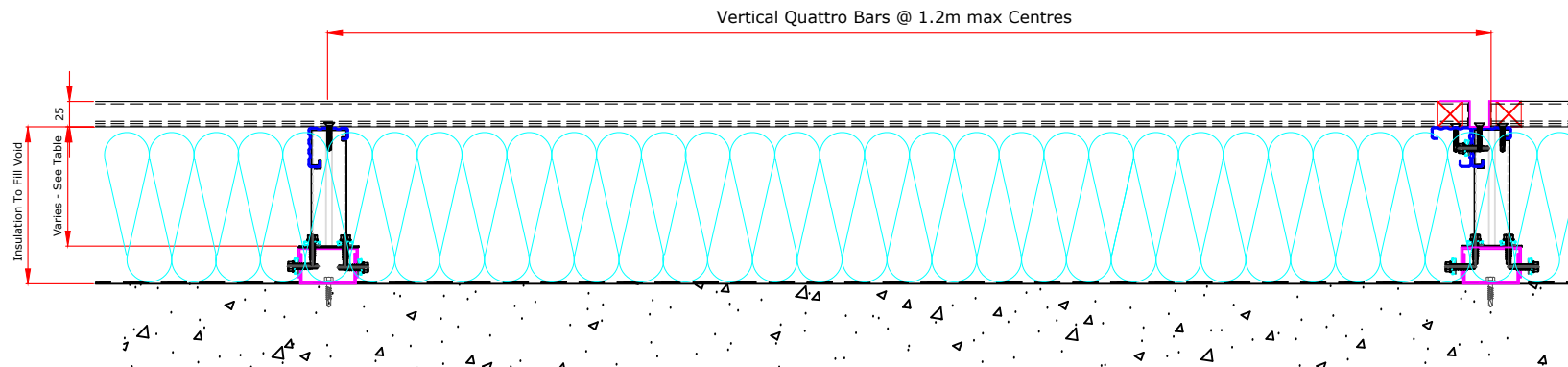

Refresh Wall Brick/Block Existing with Horizontal Opus Plank Outer Profile			
Quattro Bracket Height	Insulation Thickness *	Insulation Value	Minimum U Value with Rails at 1.2M & Brackets at 1.5M Centres
120mm	160mm	0.040	0.36
140mm	180mm	0.040	0.31
160mm	200mm	0.040	0.27
180mm	220mm	0.040	0.24
200mm	240mm	0.040	0.22
220mm	260mm	0.040	0.20

\* Insulation thickness is increased to allow for cleats/ tophats, typically based on Quattro bracket depth + 40mm.

No allowance made for performance of block/brick wall in U value stated.

TITLE: Refresh Wall Brick/Block Existing with Horizontal Plank Outer Profile  
DWG NO:  
DRAWN: EP  
CHECK: PCL  
DATE: May 2017  
SCALE: NTS

This draft drawing has been supplied by Euro Clad Ltd for the purpose of guidance free of charge. It is a suggested typical detail and as such should not be assumed suitable for any specific project or application. No responsibility is assumed for errors or misinterpretations resulting from the information contained in the drawing. Details are for illustration only and no liability is accepted. We reserve the right to change the details without notice. The drawing is copyright, it remains our property.

To be read in conjunction with Refresh guidance and specification documents

**Please Note:**

WT75 Self Adhesive Barrier Tape must be used on Quattro rails when aluminium Opus is being used.

**REFRESH WALL WITH HORIZONTAL OPUS PLANK VERTICAL JOINT DETAIL**

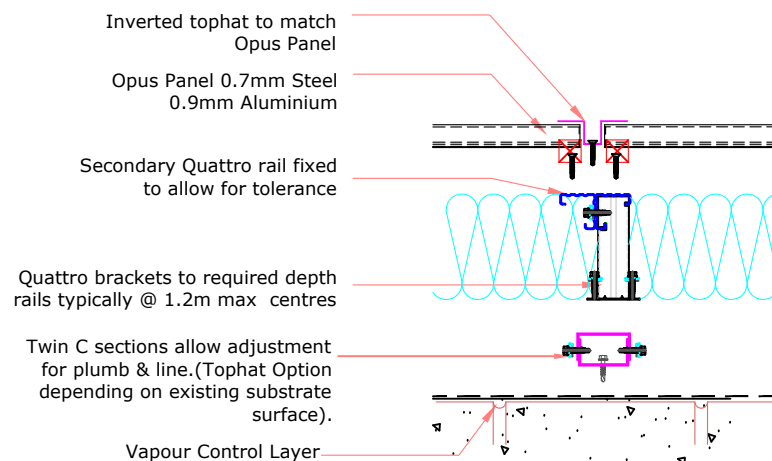

**REFRESH WALL WITH HORIZONTAL OPUS PLANK HORIZONTAL JOINT DETAIL**

Opus Plank to be installed from top down.

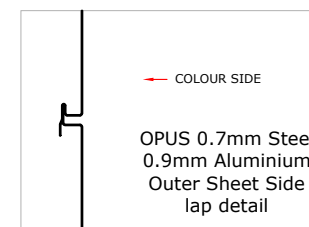
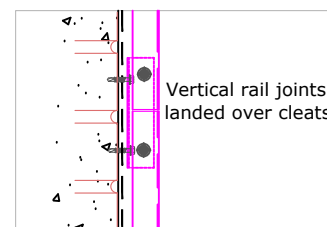
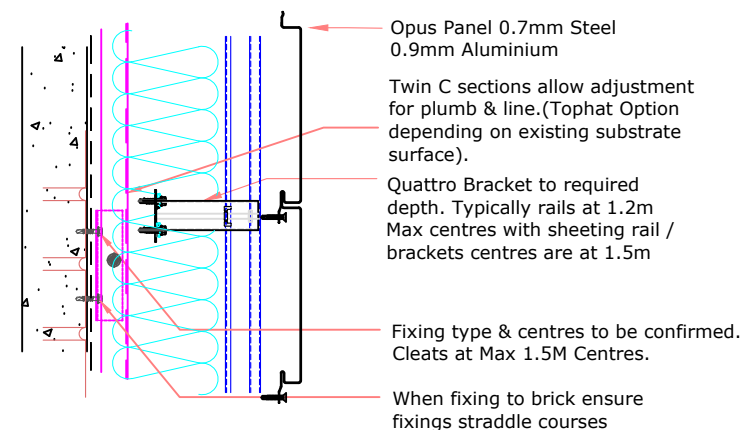

**OPUS 200 PLANK EXTERNAL SHEET**

**NB: Module = Face + Gap size**  
**Gap size should be kept uniform with the use of packers**

TITLE: Refresh Wall Brick/Block Existing with Horizontal Plank Outer Profile

DWG NO:  
 DRAWN: EP  
 CHECK: PCL  
 DATE: May 2017  
 SCALE: NTS

This draft drawing has been supplied by Euro Clad Ltd for the purpose of guidance free of charge. It is a suggested typical detail and as such should not be assumed suitable for any specific project or application. No responsibility is assumed for errors or misinterpretations resulting from the information contained in the drawing. Details are for illustration only and no liability is accepted. We reserve the right to change the details without notice. The drawing is copyright, it remains our property.

To be read in conjunction with Refresh guidance and specification documents

**Plank 200mm Module**

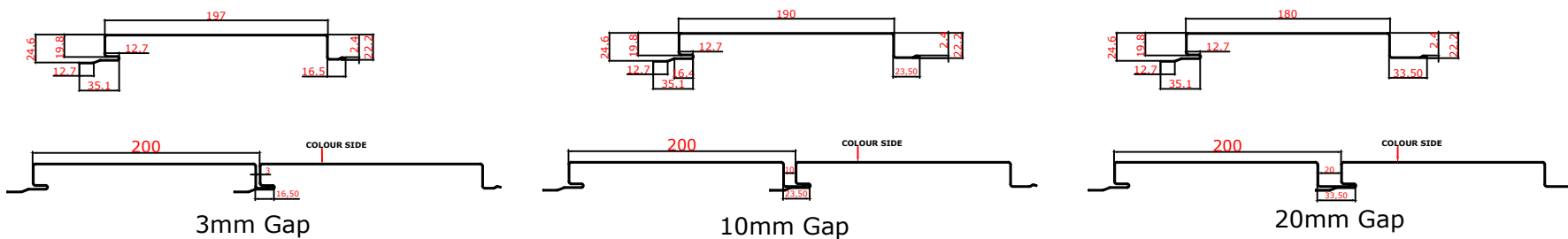

TITLE: Refresh Wall Brick/Block Existing with Horizontal Plank Outer Profile

DWG NO:  
 DRAWN: EP  
 CHECK: PCL  
 DATE: May 2017  
 SCALE: NTS

This draft drawing has been supplied by Euro Clad Ltd for the purpose of guidance free of charge. It is a suggested typical detail and as such should not be assumed suitable for any specific project or application. No responsibility is assumed for errors or misinterpretations resulting from the information contained in the drawing. Details are for illustration only and no liability is accepted. We reserve the right to change the details without notice. The drawing is copyright, it remains our property.

To be read in conjunction with Refresh guidance and specification documents

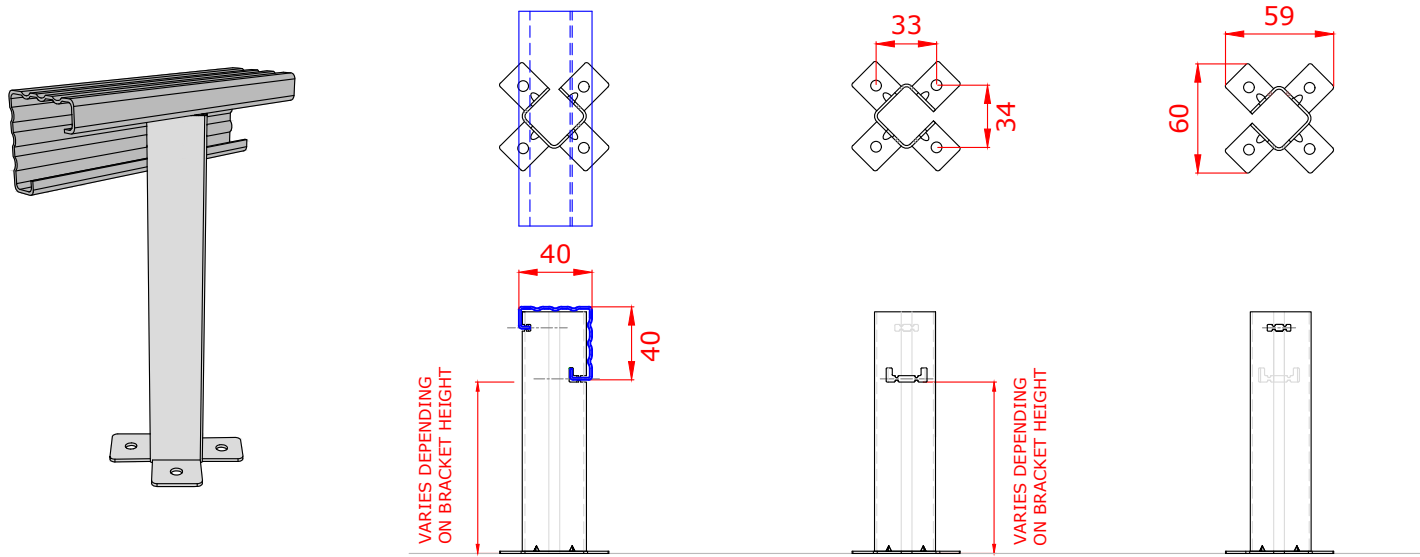

Brackets less than 260mm require 2 fixings diagonally opposite.  
 Brackets 260mm or more require 4 fixings.

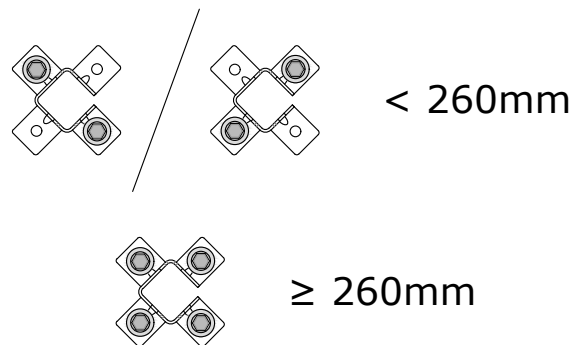

TITLE: Refresh Wall Brick/Block  
Existing with Horizontal Plank Outer  
Profile

DWG NO:

DRAWN: EP

CHECK: PCL

DATE: May 2017

SCALE: NTS

This draft drawing has been supplied by Euro Clad Ltd for the purpose of guidance free of charge. It is a suggested typical detail and as such should not be assumed suitable for any specific project or application. No responsibility is assumed for errors or misinterpretations resulting from the information contained in the drawing. Details are for illustration only and no liability is accepted. We reserve the right to change the details without notice. The drawing is copyright, it remains our property.

To be read in conjunction with Refresh guidance and specification documents

**Galv 'C' Rails and cleats are preferable  
when wall surface is uneven and allows for adjustment.**

**\*Cleat depth can be adjusted  
according to site requirements**

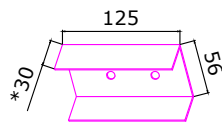
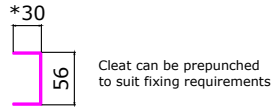

**Material: 1.5mm Galv**

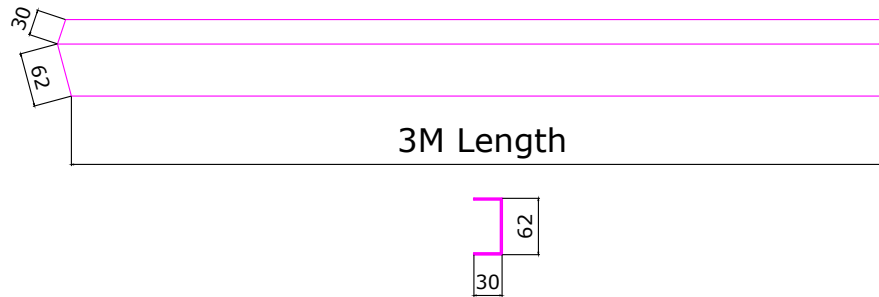

**Tophats can be considered if wall surface  
is even with little variation.**

**\*Tophat depth can be adjusted  
according to site requirements**

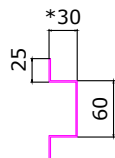

**Material: 1.5mm Galv**

